



GLOBE VALVES - CAST STEEL GLOBE VALVES



Globe valves work on the basis of port vs disc / plug flow opening percentage. It means that fluid passes through a specific opening which is variable because of the contour design of plug or disc. Due to this design, there is not a fixed passageway like gate valve. The opening can be increased or decreased to control the flow by vertical movement of stem. These valves are generally designed with the terminology of equal percentage, quick opening and closing and linear type of characteristics. These characteristics define the opening % vs the downstream flow %.



DESIGN STANDARD	
Bolted Bonnet Globe Valve	BS 1873 & ASME B16.34
Pressure Seal Globe Valve (Long & Short pattern)	ASME B16.34
Face to Face / End to End Dimensions	ASME B16.10 / ISO 5752
End Flanged dimensions	ASME B16.5 / ISO 7005-1, ASME B16.47-A&B MSS SP-44 & API 605
Butt-weld End dimensions	ASME B16.25
Valve inspection & testing	BS1873, ISO 5208, BS 6755, EN 17266
Pressure - Temperature rating	ASME B16.34

TEST / INSPECTION	METHOD	ACCEPTANCE CRITERIA
Visual Inspection		MSS SP-55
Marking		MSS SP-25 & ISO5208
Dimensional Inspection		Applicable valve
Chemical Analysis	ASTM E350	Applicable Standard
Mechanical Properties	ASTM A370	Applicable Standard
Liquid Penetrant Inspection	ASTM A165	ASME B16.34
Magnetic Particle Inspection	ASTM E709	ASME B16.34
Radiographic Inspection	ASME B16.34	ASME B16.34
Ultrasonic Inspection	ASTM A388	ASME B16.34
Pressure Testing	API 598 / ISO 5208	API 598 / ISO 5208

API 600 TRIM CHART			
API 600 TRIM N ^o	Nominal TRIM	Stem / Backseat	Seating Surface Body / Wedge
1	F6	13Cr	13Cr
2	304	18Cr-8Ni	18Cr-8Ni
3	F310	25Cr-20Ni	25Cr-20Ni
4	Hard F6	13Cr	Hard 13Cr
5	Hardfaced	13Cr	Co-Cr A
5A	Hardfaced	13Cr	Ni-Cr
6	F6 and Cu-Ni	13Cr	13Cr and Cu-Ni
7	F6 and Hard F6	13Cr	13Cr and Hard 13Cr
8	F6 and Hardfaced	13Cr	13Cr and Co-Cr A
8A	F6 and Hardfaced	13Cr	13Cr and Ni-Cr
9	Monel	Ni-Cu Alloy	Ni-Cu Alloy
10	316	18Cr-8Ni-Mo	18Cr-8Ni-Mo
11	Monel and Hardfaced	Ni-Cu Alloy	Ni-Cu Alloy and Trim 5 or 5A
12	316 and Hardfaced	18Cr-8Ni-Mo	18Cr-8Ni-Mo and Trim 5 or 5A
13	Alloy 20	19Cr-29Ni	19Cr-29Ni
14	Alloy 20 and Hardfaced	19Cr-29Ni	19Cr-29Ni and Trim 5 or 5A
15	Hardfaced	18Cr-8Ni	Co-Cr A
16	Hardfaced	18Cr-8Ni-Mo	Co-Cr A
17	Hardfaced	18Cr-10Ni-Cb	Co-Cr A
18	Hardfaced	19Cr-29Ni	Co-Cr A





GLOBE VALVES - CAST STEEL GLOBE VALVES - 150# & 300#

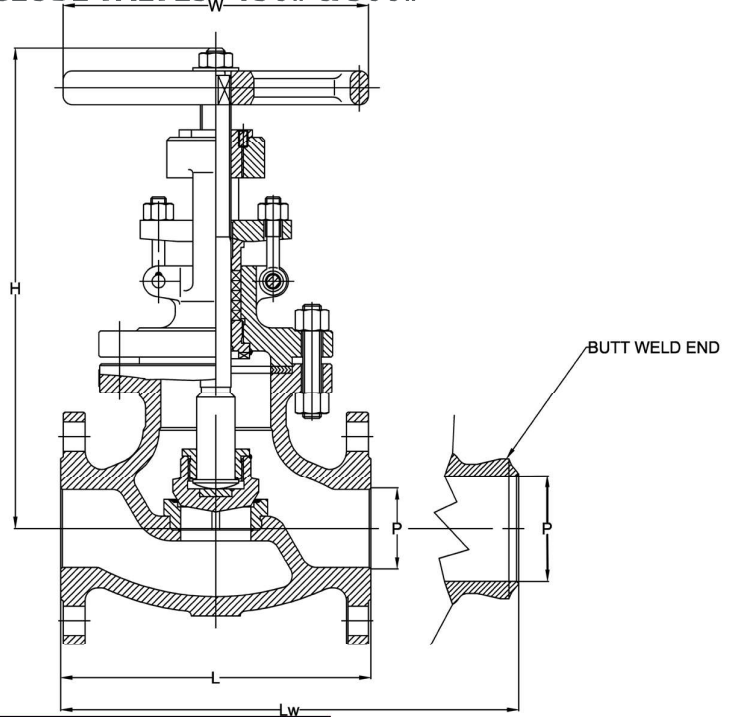

150#					
DN (inch)	L	Lw	H	W	WEIGHT (Kg) Approx
50 (2")	203	203	341	200	22
65 (2½")	216	216	367	250	29
80 (3")	241	241	375	250	40
100 (4")	292	292	483	300	64
125 (5")	356	356	537	300	77
150 (6")	406	406	517	350	105
200 (8")	495	495	590	400	154
250 (10")	622	622	754	450	288
300 (12")	698	698	941	640	507
350 (14")	787	787	1085	640	520
400 (16")	914	914	1250	460 (*)	810 (*)

(Code-SS)

300#					
DN (inch)	L	Lw	H	W	WEIGHT (Kg) Approx
50 (2")	267	267	349	200	31
65 (2½")	292	292	376	250	43
80 (3")	318	318	430	250	57
100 (4")	356	356	486	350	86
125 (5")	400	400	560	400	130
150 (6")	444	444	618	450	168
200 (8")	559	559	937	560	280
250 (10")	622	622	949	640	385
300 (12")	711	711	995	460 (*)	671 (*)

(Code-SS)





GLOBE VALVES - CAST STEEL GLOBE VALVES - 600#, 900#, 1500# & 2500#

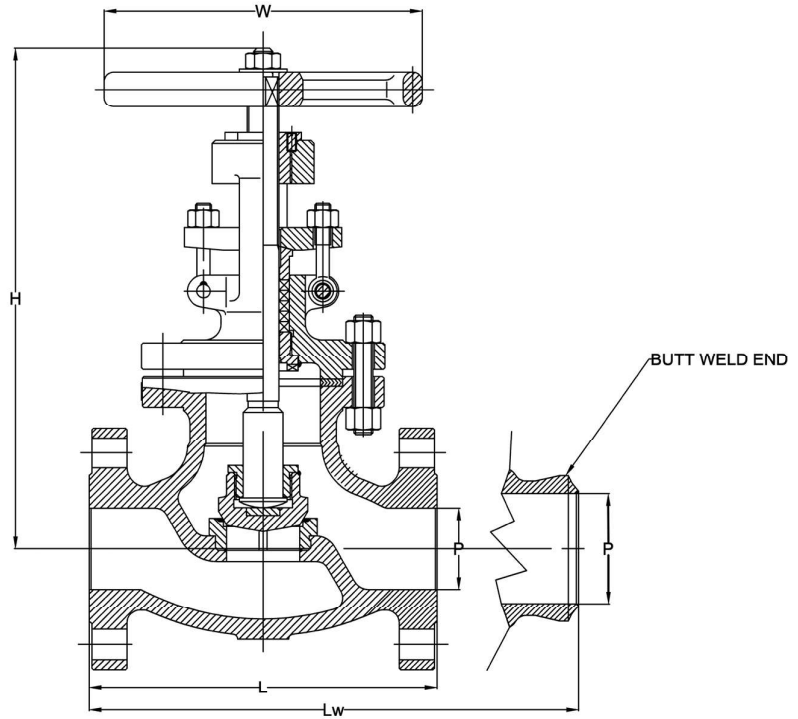

600#					
DN (inch)	L	Lw	H	W	WEIGHT (Kg) Approx
50 (2")	292	292	425	250	35
65 (2½")	330	330	502	300	48
80 (3")	356	356	521	350	73
100 (4")	432	432	620	450	117
125 (5")	508	508	756	500	245
150 (6")	559	559	886	560	327
200 (8")	660	660	932	460 (*)	482 (*)
250 (10")	787	787	1040	610 (*)	700 (*)
300 (12")	838	838	1280	760 (*)	900 (*)

(Code-SS)

1500#					
DN (inch)	L	Lw	H	W	WEIGHT (Kg) Approx
50 (2")	368	368	592	350	112
65 (2½")	419	419	605	450	175
80 (3")	470	470	692	450	228
100 (4")	546	546	907	460 (*)	336 (*)
125 (5")	673	673	965	560 (*)	585 (*)
150 (6")	705	705	1015	610 (*)	822 (*)
200 (8")	832	832	1145	610 (*)	960 (*)

(Code-SS)

900#					
DN (inch)	L	Lw	H	W	WEIGHT (Kg) Approx
50 (2")	368	368	478	350	105
65 (2½")	419	419	550	350	120
80 (3")	381	381	614	450	131
100 (4")	457	457	789	560	218
150 (6")	610	610	886	460 (*)	452 (*)
200 (8")	737	737	932	610 (*)	710 (*)

(Code-SS)

2500#					
DN (inch)	L	Lw	H	W	WEIGHT (Kg) Approx
50 (2")	451	451	635	350	135
65 (2½")	508	508	690	450	270
80 (3")	578	578	745	460	335
100 (4")	673	673	975	560 (*)	510 (*)
125 (5")	794	794	1025	610 (*)	730 (*)
150 (6")	914	914	1105	610 (*)	995 (*)
200 (8")	1022	1022	1225	610 (*)	1185 (*)

(Code-SS)