

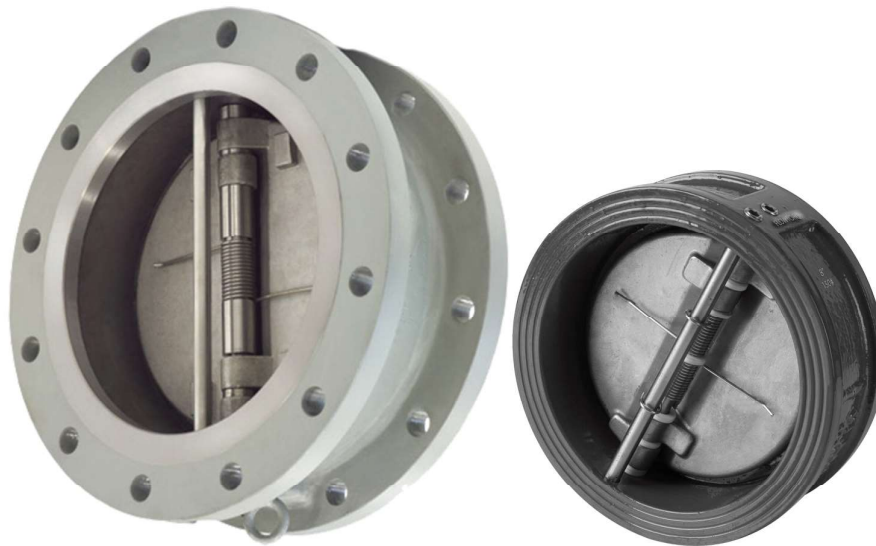

CHECK VALVES - DUAL PLATE CHECK VALVES



Comparatively lighter in weight and compact in construction with swing check valves, Dual Plate Check Valves provide cutting edge technology and application in oil & gas, petrochemical, chemical, power and other process industries. It houses two separate discs hinged to a stem (hinge pin) and forced by a spring for closing while on other hand force of service medium serves to open. Ideal for backflow prevention, pump outlet, prevent gravitational drainage, etc.



DESIGN STANDARD	
Dual Plate Check Valve	API594, ASME B16.34 & API 6D
Face to Face / End to End Dimensions	API594, ASME B16.5, ASME B16.47
Valve inspection & testing	API598
Pressure - Temperature rating	ASME B16.34

TEST / INSPECTION	METHOD	ACCEPTANCE CRITERIA
Visual Inspection		MSS SP-55
Marking		MSS SP-25 & ISO5208
Dimensional Inspection		Applicable valve
Chemical Analysis	ASTM E350	Applicable Standard
Mechanical Properties	ASTM A370	Applicable Standard
Liquid Penetrant Inspection	ASTM A165	ASME B16.34
Magnetic Particle Inspection	ASTM E709	ASME B16.34
Radiographic Inspection	ASME B16.34	ASME B16.34
Ultrasonic Inspection	ASTM A388	ASME B16.34
Pressure Testing	API 598	API 598



CHECK VALVES - DUAL PLATE CHECK VALVES



Comparatively lighter in weight and compact in construction with swing check valves, Dual Plate Check Valves provide cutting edge technology and application in oil & gas, petrochemical, chemical, power and other process industries. It houses two separate discs hinged to a stem (hinge pin) and forced by a spring for closing while on other hand force of service medium serves to open. Ideal for backflow prevention, pump outlet, prevent gravitational drainage, etc.

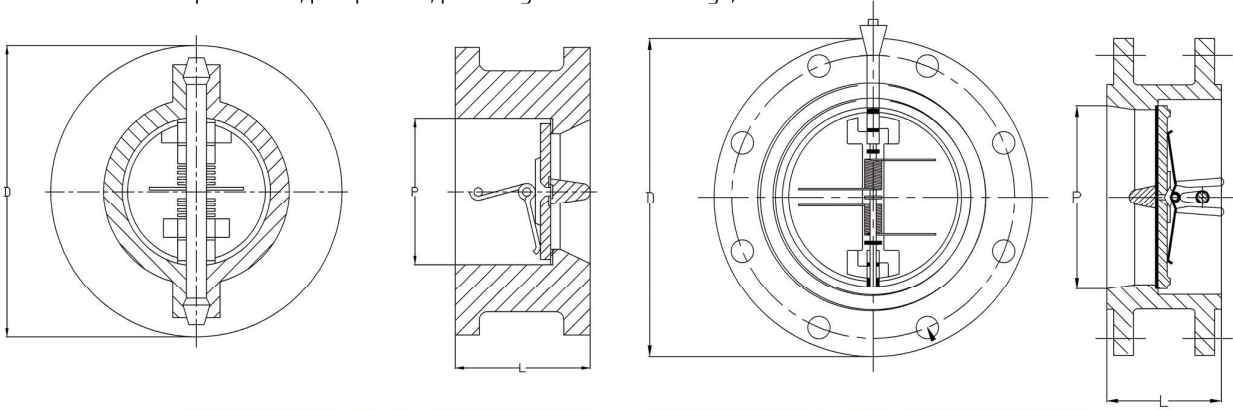

150# - Wafer Type				
DN (inch)	P	D	L	WEIGHT (Kg) Approx
50 (2")	60	105	60	2.4
65 (2½")	73	124	67	4.3
80 (3")	89	137	73	5.7
100 (4")	114	175	73	7.5
125 (5")	141	197	86	12
150 (6")	168	222	98	16
200 (8")	219	279	127	33
250 (10")	273	340	146	50
300 (12")	324	410	181	79
350 (14")	356	451	184	93
400 (16")	406	514	191	159
450 (18")	457	549	203	178
500 (20")	508	606	219	234
600 (24")	610	718	222	740
650 (26")	660	773	222	692
700 (28")	711	832	305	835
750 (30")	762	883	305	665
800 (32")	813	940	356	1197

(Code - SV)

150# - Flange Type				
DN (inch)	P	D	L	WEIGHT (Kg) Approx
50 (2")	60	165	60	7.4
65 (2½")	73	191	67	7.4
80 (3")	89	210	73	8.4
100 (4")	114	229	73	13.5
125 (5")	141	254	86	16
150 (6")	168	279	98	22
200 (8")	219	343	127	44
250 (10")	273	406	146	86
300 (12")	324	483	181	100
350 (14")	356	533	184	127
400 (16")	406	597	191	162
450 (18")	457	635	203	190
500 (20")	508	699	219	254
600 (24")	610	813	222	403
650 (26")	660	870	222	482
700 (28")	711	927	305	543
750 (30")	762	984	305	696
800 (32")	813	1060	356	855

(Code - SV)

300# - Wafer Type				
DN (inch)	P	D	L	WEIGHT (Kg) Approx
50 (2")	60	111	60	3
65 (2½")	73	130	67	5
80 (3")	89	149	73	7
100 (4")	114	181	73	9
125 (5")	141	216	86	14
150 (6")	168	251	98	18
200 (8")	219	308	127	37
250 (10")	273	362	146	55
300 (12")	324	422	181	87
350 (14")	356	486	222	103
400 (16")	406	540	232	175
450 (18")	457	597	264	196
500 (20")	508	654	292	258
600 (24")	610	775	318	383
650 (26")	660	835	318	814
700 (28")	711	903	318	762
750 (30")	762	953	368	919
800 (32")	813	1006	368	732

(Code - SV)

300# - Flange Type				
DN (inch)	P	D	L	WEIGHT (Kg) Approx
50 (2")	60	165	60	10
65 (2½")	73	191	67	10
80 (3")	89	210	73	11
100 (4")	114	254	73	18
125 (5")	141	279	86	21
150 (6")	168	318	98	29
200 (8")	219	381	127	58
250 (10")	273	445	146	112
300 (12")	324	521	181	130
350 (14")	356	584	222	166
400 (16")	406	648	232	211
450 (18")	457	711	264	247
500 (20")	508	775	292	331
600 (24")	610	914	318	524
650 (26")	660	972	318	627
700 (28")	711	1035	318	706
750 (30")	762	1092	368	905
800 (32")	813	1149	368	1112

(Code - SV)

600# - Wafer Type				
DN (inch)	P	D	L	WEIGHT (Kg) Approx
50 (2")	60	111	60	4
65 (2½")	73	130	67	6
80 (3")	89	149	73	9
100 (4")	114	194	79	11
125 (5")	141	241	105	17
150 (6")	168	267	136	22
200 (8")	219	321	165	45
250 (10")	273	400	213	66
300 (12")	324	457	229	105
350 (14")	356	492	273	124
400 (16")	406	565	305	210
450 (18")	457	613	362	236
500 (20")	508	683	368	310
600 (24")	610	791	438	460
650 (26")	660	867	438	977
700 (28")	711	915	438	915
750 (30")	762	968	505	1103
800 (32")	813	1024	505	879

(Code - SV)

600# - Flange Type				
DN (inch)	P	D	L	WEIGHT (Kg) Approx
50 (2")	60	60	165	13
65 (2½")	73	67	191	13
80 (3")	89	73	210	15
100 (4")	114	79	273	24
125 (5")	141	105	330	28
150 (6")	168	136	356	38
200 (8")	219	165	419	76
250 (10")	273	213	508	146
300 (12")	324	229	559	169
350 (14")	356	273	603	216
400 (16")	406	305	686	275
450 (18")	457	362	743	322
500 (20")	508	368	813	431
600 (24")	610	438	940	682
650 (26")	660	438	1016	816
700 (28")	711	438	1073	918
750 (30")	762	505	1130	1177
800 (32")	813	505	1194	1446

(Code - SV)

